



Shipboard Hot-Cold Serving Line Dresser

Technical Manual

Installation, Operation, and Maintenance Instructions

Models:

LPD242

USS Mesa Verde
(LPD-19)

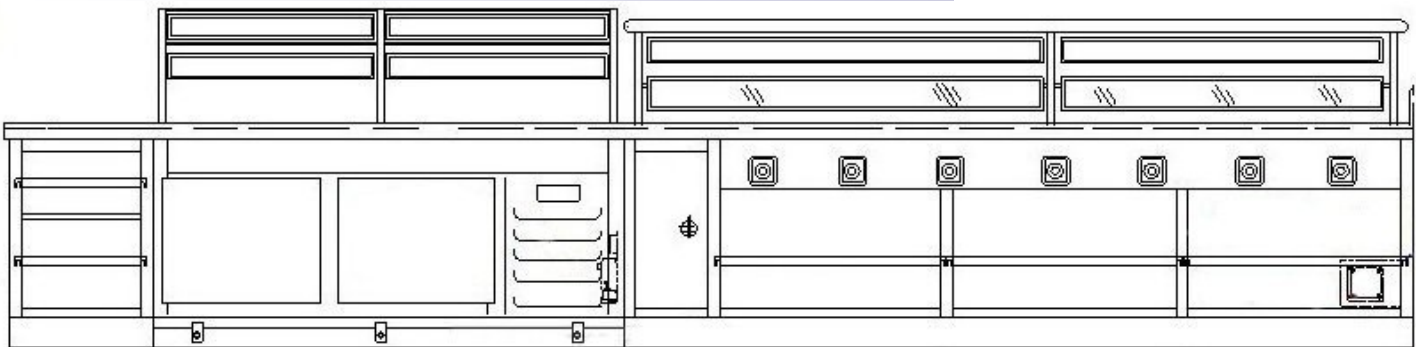
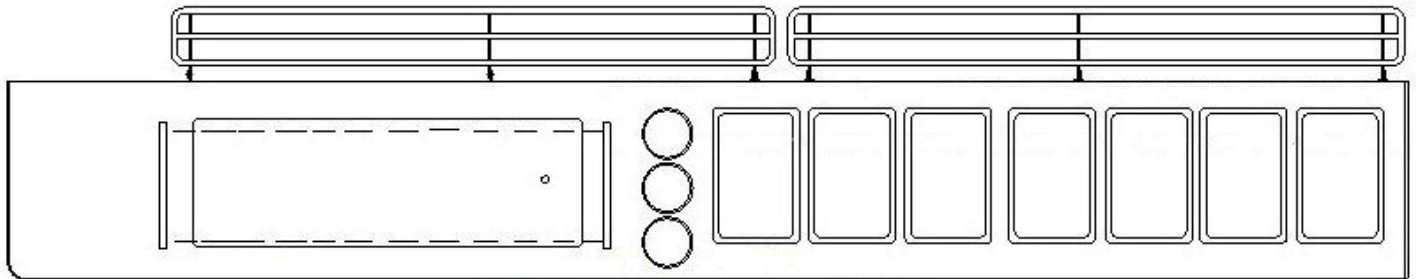

Table of Contents

Drawings

1.A General Arrangement Drawing.....	3
1.B Cold Food Counter Drawing.....	4
1.C Heated Dresser Drawing.....	5
1.D Display Drawing.....	6
1.E 2-Tier Display Drawing.....	7
1.F Tray Rail Drawing.....	8
1.G Dry Storage Cabinet Drawing.....	9

Bill of Materials

Table A Bill of Materials—LPD242	10-12
----------------------------------	-------

Illustration 1.A – General Arrangement Drawing

RELEVANT DRAWINGS

DRAWING #	DESCRIPTION
91078	MAIN DRAWING
91078-1	COLD FOOD COUNTER BODY
91078-1+	HOT WELLS/ DRY STORAGE CABINET
91078-1++	DRY STORAGE CABINET
91078-2	FOUNDATION (COLDFOOD COUNTER)
91078-3	FOUNDATION (HOTWELL/ DRY STORAGE)
91078-3++	FOUNDATION (DRY STORAGE)
91078-4	TOP
91078-5	SANITARY SNIFFER SHIELD
91078-6	DISPLAY
91078-6	TRAY SLIDE
91078A	TYPICAL FOUNDATION (refrigerated)
91078-1C	TYPICAL FOUNDATION (dry storage)
91078-8D	TOP DETAILS
91078-8E	TYPICAL CABINET COMPONENTS

ASSEMBLY ITEMS

DESCRIPTION	QTY	UNIT	ITEM #	DESCRIPTION	QTY	UNIT	ITEM #
FOUNDATION	1	EA	91078-3	FOUNDATION (DRY STORAGE)	1	EA	91078-3++
CABINET BODY	1	EA	91078-1	FOUNDATION (HOTWELL/ DRY STORAGE)	1	EA	91078-3
TOP	1	EA	91078-4	TOP	1	EA	91078-4
LEADS, 8' POWER	1	EA	91078-10	LEADS, 8' POWER	1	EA	91078-10
ROD, LATCH	1	EA	91078-11	ROD, LATCH	1	EA	91078-11
WHEEL	1	EA	91078-12	WHEEL	1	EA	91078-12
WHEEL	1	EA	91078-13	WHEEL	1	EA	91078-13
WHEEL	1	EA	91078-14	WHEEL	1	EA	91078-14
WHEEL	1	EA	91078-15	WHEEL	1	EA	91078-15
WHEEL	1	EA	91078-16	WHEEL	1	EA	91078-16
WHEEL	1	EA	91078-17	WHEEL	1	EA	91078-17
WHEEL	1	EA	91078-18	WHEEL	1	EA	91078-18
WHEEL	1	EA	91078-19	WHEEL	1	EA	91078-19
WHEEL	1	EA	91078-20	WHEEL	1	EA	91078-20
WHEEL	1	EA	91078-21	WHEEL	1	EA	91078-21
WHEEL	1	EA	91078-22	WHEEL	1	EA	91078-22
WHEEL	1	EA	91078-23	WHEEL	1	EA	91078-23
WHEEL	1	EA	91078-24	WHEEL	1	EA	91078-24
WHEEL	1	EA	91078-25	WHEEL	1	EA	91078-25
WHEEL	1	EA	91078-26	WHEEL	1	EA	91078-26
WHEEL	1	EA	91078-27	WHEEL	1	EA	91078-27
WHEEL	1	EA	91078-28	WHEEL	1	EA	91078-28
WHEEL	1	EA	91078-29	WHEEL	1	EA	91078-29
WHEEL	1	EA	91078-30	WHEEL	1	EA	91078-30
WHEEL	1	EA	91078-31	WHEEL	1	EA	91078-31
WHEEL	1	EA	91078-32	WHEEL	1	EA	91078-32
WHEEL	1	EA	91078-33	WHEEL	1	EA	91078-33
WHEEL	1	EA	91078-34	WHEEL	1	EA	91078-34
WHEEL	1	EA	91078-35	WHEEL	1	EA	91078-35
WHEEL	1	EA	91078-36	WHEEL	1	EA	91078-36
WHEEL	1	EA	91078-37	WHEEL	1	EA	91078-37
WHEEL	1	EA	91078-38	WHEEL	1	EA	91078-38
WHEEL	1	EA	91078-39	WHEEL	1	EA	91078-39
WHEEL	1	EA	91078-40	WHEEL	1	EA	91078-40
WHEEL	1	EA	91078-41	WHEEL	1	EA	91078-41
WHEEL	1	EA	91078-42	WHEEL	1	EA	91078-42
WHEEL	1	EA	91078-43	WHEEL	1	EA	91078-43
WHEEL	1	EA	91078-44	WHEEL	1	EA	91078-44
WHEEL	1	EA	91078-45	WHEEL	1	EA	91078-45
WHEEL	1	EA	91078-46	WHEEL	1	EA	91078-46
WHEEL	1	EA	91078-47	WHEEL	1	EA	91078-47
WHEEL	1	EA	91078-48	WHEEL	1	EA	91078-48
WHEEL	1	EA	91078-49	WHEEL	1	EA	91078-49
WHEEL	1	EA	91078-50	WHEEL	1	EA	91078-50
WHEEL	1	EA	91078-51	WHEEL	1	EA	91078-51
WHEEL	1	EA	91078-52	WHEEL	1	EA	91078-52
WHEEL	1	EA	91078-53	WHEEL	1	EA	91078-53
WHEEL	1	EA	91078-54	WHEEL	1	EA	91078-54
WHEEL	1	EA	91078-55	WHEEL	1	EA	91078-55
WHEEL	1	EA	91078-56	WHEEL	1	EA	91078-56
WHEEL	1	EA	91078-57	WHEEL	1	EA	91078-57
WHEEL	1	EA	91078-58	WHEEL	1	EA	91078-58
WHEEL	1	EA	91078-59	WHEEL	1	EA	91078-59
WHEEL	1	EA	91078-60	WHEEL	1	EA	91078-60
WHEEL	1	EA	91078-61	WHEEL	1	EA	91078-61
WHEEL	1	EA	91078-62	WHEEL	1	EA	91078-62
WHEEL	1	EA	91078-63	WHEEL	1	EA	91078-63
WHEEL	1	EA	91078-64	WHEEL	1	EA	91078-64
WHEEL	1	EA	91078-65	WHEEL	1	EA	91078-65
WHEEL	1	EA	91078-66	WHEEL	1	EA	91078-66
WHEEL	1	EA	91078-67	WHEEL	1	EA	91078-67
WHEEL	1	EA	91078-68	WHEEL	1	EA	91078-68
WHEEL	1	EA	91078-69	WHEEL	1	EA	91078-69
WHEEL	1	EA	91078-70	WHEEL	1	EA	91078-70
WHEEL	1	EA	91078-71	WHEEL	1	EA	91078-71
WHEEL	1	EA	91078-72	WHEEL	1	EA	91078-72
WHEEL	1	EA	91078-73	WHEEL	1	EA	91078-73
WHEEL	1	EA	91078-74	WHEEL	1	EA	91078-74
WHEEL	1	EA	91078-75	WHEEL	1	EA	91078-75
WHEEL	1	EA	91078-76	WHEEL	1	EA	91078-76
WHEEL	1	EA	91078-77	WHEEL	1	EA	91078-77
WHEEL	1	EA	91078-78	WHEEL	1	EA	91078-78
WHEEL	1	EA	91078-79	WHEEL	1	EA	91078-79
WHEEL	1	EA	91078-80	WHEEL	1	EA	91078-80
WHEEL	1	EA	91078-81	WHEEL	1	EA	91078-81
WHEEL	1	EA	91078-82	WHEEL	1	EA	91078-82
WHEEL	1	EA	91078-83	WHEEL	1	EA	91078-83
WHEEL	1	EA	91078-84	WHEEL	1	EA	91078-84
WHEEL	1	EA	91078-85	WHEEL	1	EA	91078-85
WHEEL	1	EA	91078-86	WHEEL	1	EA	91078-86
WHEEL	1	EA	91078-87	WHEEL	1	EA	91078-87
WHEEL	1	EA	91078-88	WHEEL	1	EA	91078-88
WHEEL	1	EA	91078-89	WHEEL	1	EA	91078-89
WHEEL	1	EA	91078-90	WHEEL	1	EA	91078-90
WHEEL	1	EA	91078-91	WHEEL	1	EA	91078-91
WHEEL	1	EA	91078-92	WHEEL	1	EA	91078-92
WHEEL	1	EA	91078-93	WHEEL	1	EA	91078-93
WHEEL	1	EA	91078-94	WHEEL	1	EA	91078-94
WHEEL	1	EA	91078-95	WHEEL	1	EA	91078-95
WHEEL	1	EA	91078-96	WHEEL	1	EA	91078-96
WHEEL	1	EA	91078-97	WHEEL	1	EA	91078-97
WHEEL	1	EA	91078-98	WHEEL	1	EA	91078-98
WHEEL	1	EA	91078-99	WHEEL	1	EA	91078-99
WHEEL	1	EA	91078-100	WHEEL	1	EA	91078-100

ITEM: 242

SHEET: 10

MODEL:

NOTES:
 REVISIONS: 1/8/08 - Added weight, CG, and electrical connection; C: New base frames; D: Add to the assembly items list

PROJECT: HOT/COLD SERVING LINE DRESSER (PORT)
 DRAWING NO: 91078
 DATE: 09/10/08 SCALE: N.T.S. DWG. BY: CW

COSPOLICH INC.,
 MORCO, LOUISIANA

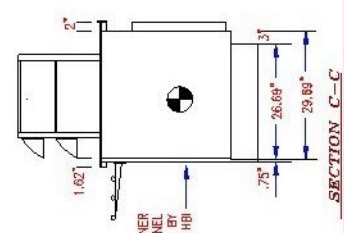
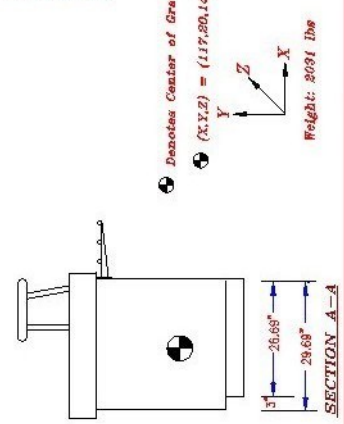
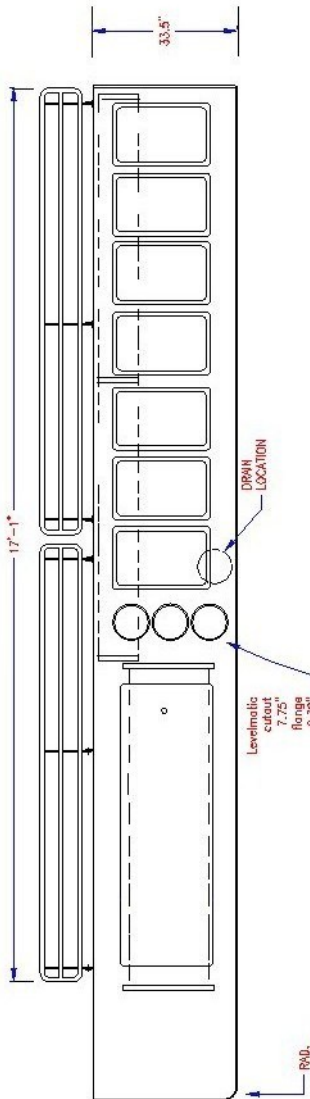
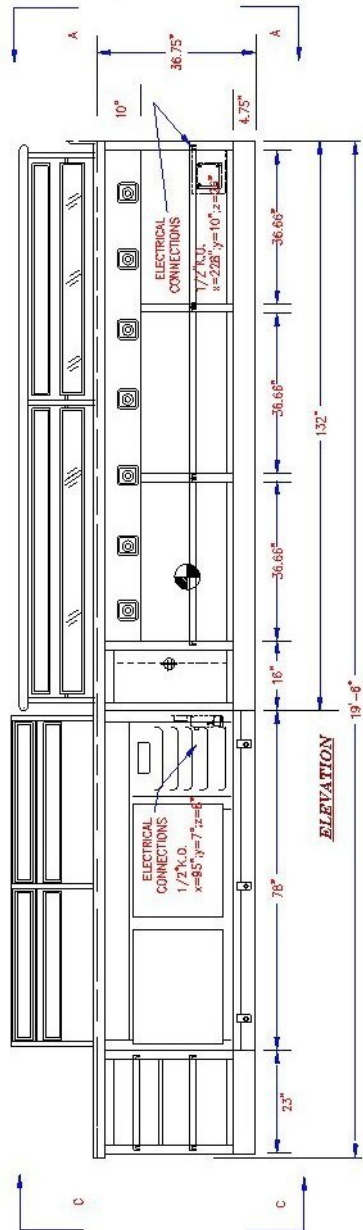
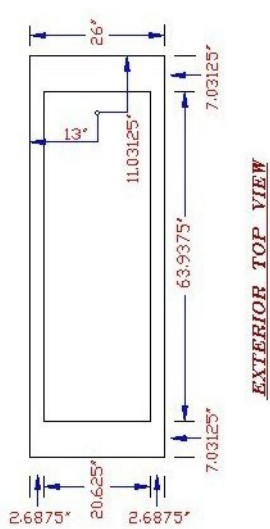
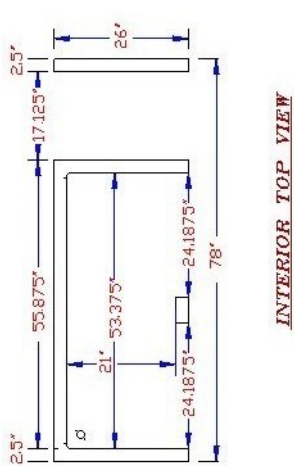
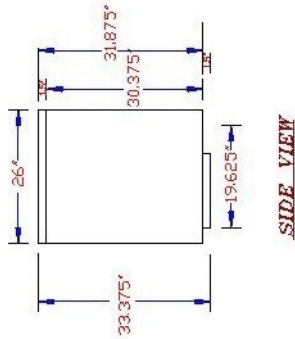
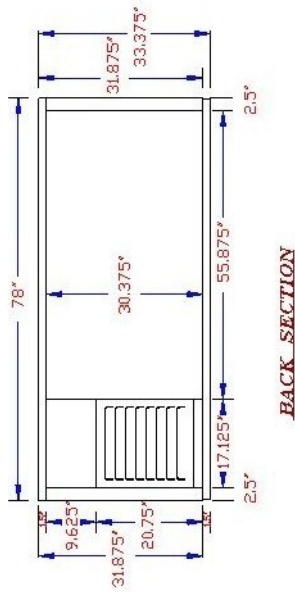
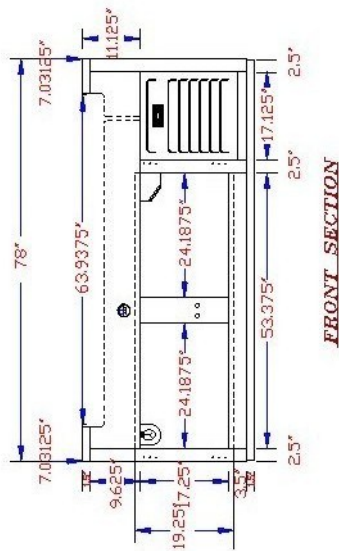

Illustration 1.B – Cold Food Counter Drawing



ITEM: 242

ITEM - HOT/COLD SERVING LINE DRESSER	DATE 10/22/02	SCALE T.S.	DWN. BY TC
PROJECT HBI/LPD-17	DATE 10/22/02	SCALE T.S.	DWN. BY TC
DATE 10/22/02	SCALE T.S.	DWN. BY TC	DWN. BY TC
COSPOLICH INC.			MOBILE, LOUISIANA

Illustration 1.C – Heated Dresser Drawing

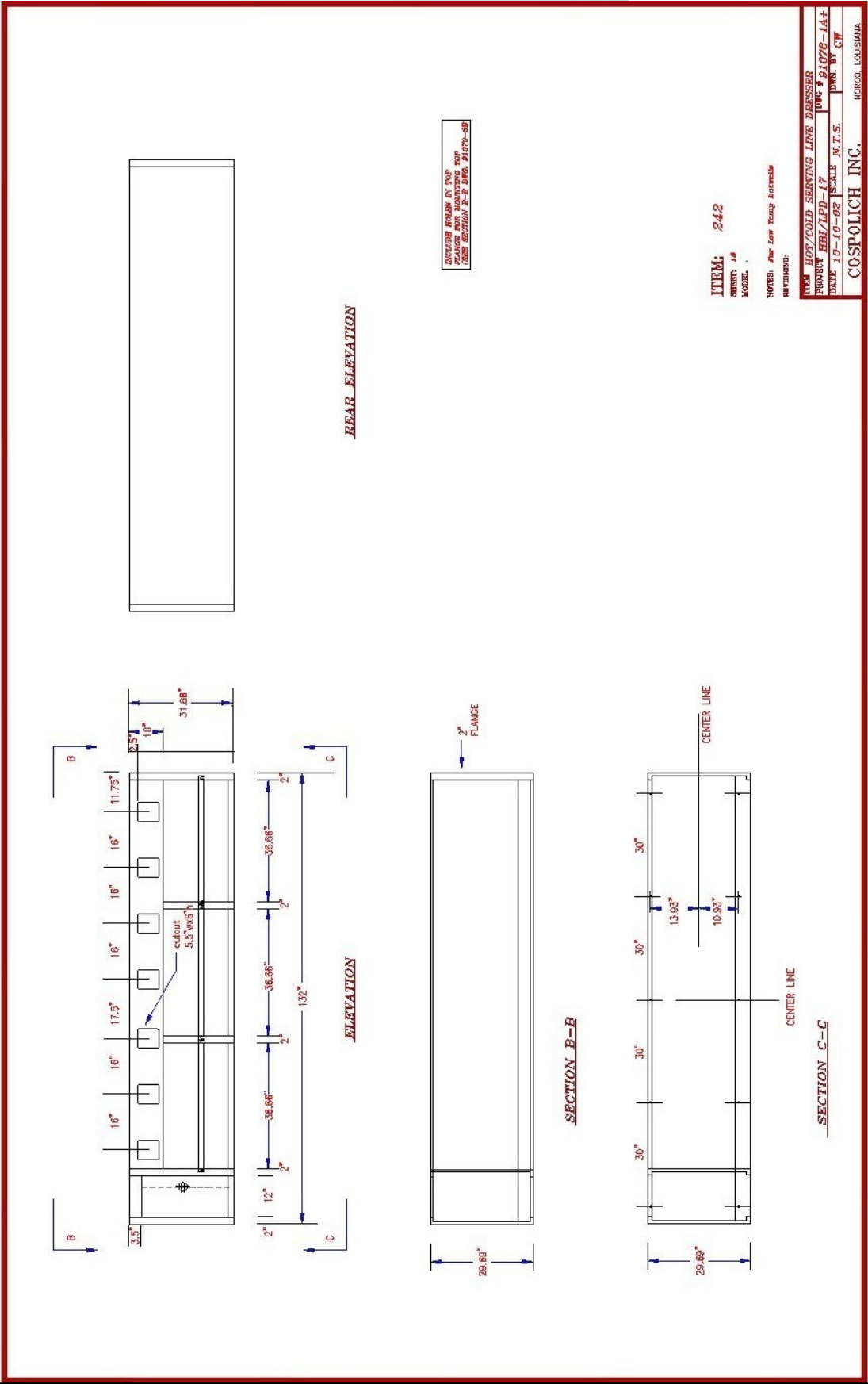
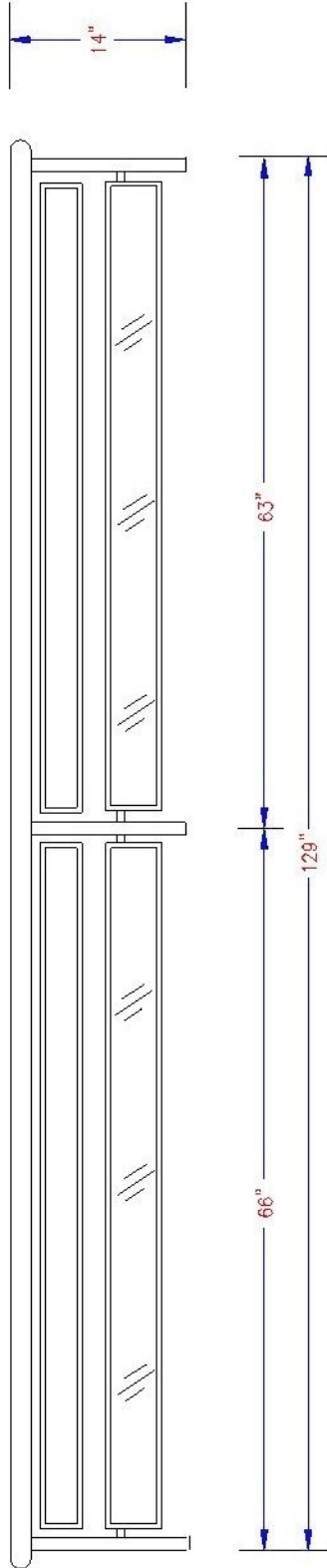

Illustration 1.D – Display Drawing



PLAN VIEW

ITEM	MATERIAL
FRAME	1.25" STAINLESS SQUARE TUBING
SHELF	16 GA. STAINLESS STEEL
SNEEZE	.25" ACRYLIC
BRACKETS	STANDARD CURVED
TRIM	.25" STAINLESS CHANNEL CAPPING

ITEM: 242
SHEET: 10

NOTES:
REVISIONS:

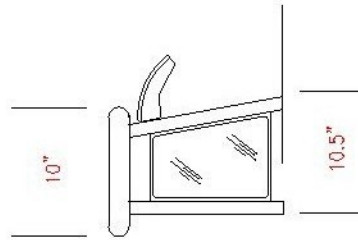

SECTION A-A

ITEM	SANITARY SNEEZE SHIELD
PROJECT	HBI/LPD-17
DATE	10/10/02
SCALE	N.T.S.
DWG #	91078-4
DWN. BY	CW
COSPOLICH INC.	
NORCO, LOUISIANA	

Illustration 1.E—2-Tier Display Drawing

ELEVATION

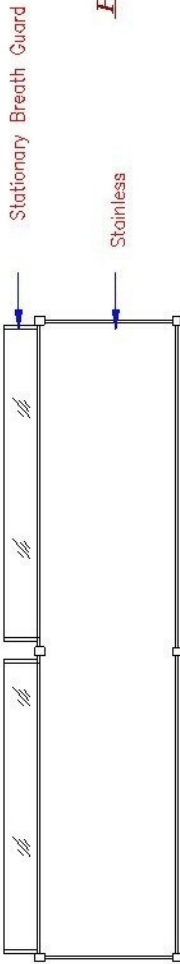
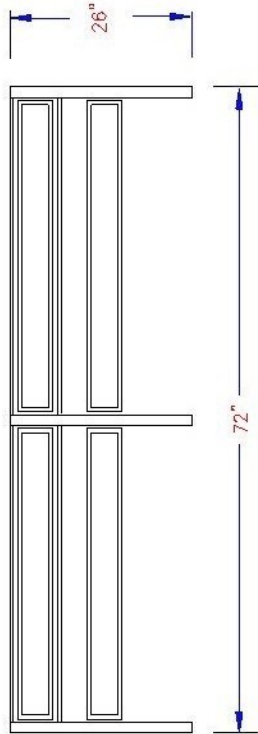

PLAN VIEW

NOTE: STANDARD CFC ST DISPLAY

ITEM: 242
SHEET: 10

NOTES:
REVISIONS:

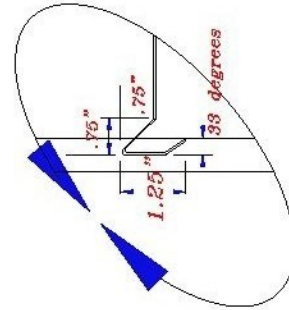

DETAIL A

All tops capped

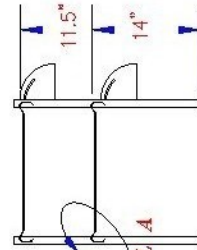

Section A-A

ITEM DISPLAY	DWG # 91078-4+
PROJECT HBI/LPD-17	DWN. BY CW
DATE 10/10/02	SCALE N.T.S.
COSPOLICH INC.	
NORCO, LOUISIANA	

Illustration 1.F – Tray Rail Drawing

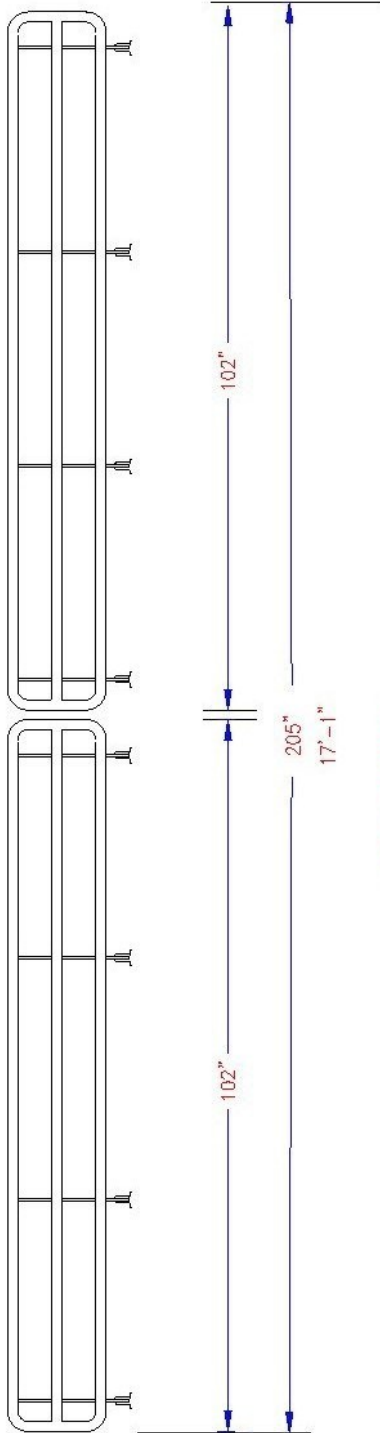

ITEM: 242
SHEET: 10

NOTES:
REVISIONS: A: Change from single to two section

ITEM	MATERIAL	LENGTH	PART #	QTY.
FRAME TUBES	1" STAINLESS ROUND TUBING	93"	MSSRT065162	6
ENDS			HTSRE01	4
BRACKETS	FIXED		HTSDF01	8
.	.			
.	.			

ITEM TRAY SLIDE
PROJECT HBI/LPD-17 DWG # 91078-5A
DATE 6/20/02 SCALE N.T.S. DWN. BY CW
COSPOLICH INC. NORCO, LOUISIANA

NOTE: Brackets will be field installed.

Illustration 1.G – Dry Storage Cabinet Drawing

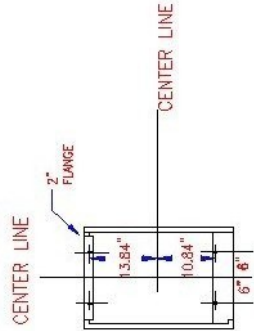

PLAN VIEW



PROFILE

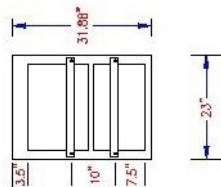

ELEVATION

ITEM: 242

SHEET: 10

NOISE:

NOTE:

REVISIONS: 08-28-05 "1" Change attachment dimensions

WORK CABINET FOR HOT/COLD LINE DRESSER	DWG # 91078-1A11
PROJECT HBI/LEP-17	DWG BY CT
DATE 9-05-02	SCALE N.T.S.

COSPOLICH INC.
MORFO, LOUISIANA

Table A – Parts List for LPD242

	ITEM	COSP#	Vendor	QTY	U/M
1	FRONT-BREATHING GRILL	GRMLPD-FB	COSPOLICH	1	EA
2	DROP-IN DISH DISPENSER	HXDIS-PDS5	COSPOLICH	3	EA
3	CONTINUOUS HINGE	HXHE20	COSPOLICH	1	EA
4	CONTROL PANEL ASSEMBLY, 115V	RCTL04N	COSPOLICH	1	EA
5	ON/OFF TOGGLE SWITCH	LWTS01	COSPOLICH	1	EA
6	THERMOSTAT	RWTT64	COSPOLICH	1	EA
7	PREPPED CONDENSING UNIT ASSEMBLY, 115V, 404A	RUT510-2-P	COSPOLICH	1	EA
8	COMPRESSOR	RUT561	COSPOLICH	1	EA
9	CONDENSER	RWCD10	COSPOLICH	1	EA
10	CONDENSER FAN MOTOR	RWCM62	COSPOLICH	1	EA
11	CONDENSER FAN BLADE	RWFB36	COSPOLICH	1	EA
12	RECEIVER TANK	RWRT35	COSPOLICH	1	EA
13	START CAPACITOR	RWCP84	COSPOLICH	1	EA
14	RELAY	RWRLY83	COSPOLICH	1	EA
15	OVERLOAD	RWOVL66	COSPOLICH	1	EA
16	SUCTION SERVICE VALVE	RWSV24	COSPOLICH	1	EA
17	PREPPED EVAPORATOR COIL ASSEMBLY, 115V, 404A	RWE010-P	COSPOLICH	1	EA
18	EVAPORATOR FAN MOTOR, 115V	RWEM03	COSPOLICH	1	EA
19	EVAPORATOR FAN GUARD	RWE5054D	COSPOLICH	1	EA
20	EVAPORATOR FAN BLADE	RWE5101B	COSPOLICH	1	EA
21	AXIAL FAN MOTOR, 115V	RWEM26	COSPOLICH	1	EA
22	VINYL TUBING, 1/2"	CVT12	COSPOLICH	10	FT
23	HEATER WIRE, 115V, 90", 32 DEGREE	L1HR90	COSPOLICH	2	EA
24	LIGHT SWITCH WITH WIRES	LRLS01W	COSPOLICH	2	EA
25	PLASTIC BREAKER BOX	PBBEK004	COSPOLICH	1	EA
26	ELECTRICAL ENCLOSURE, 8" X 10"	LENC03	COSPOLICH	1	EA
27	BACKING PLATE, 8" X 10"	LENC03B	COSPOLICH	1	EA

Table A – Parts List for LPD242

	ITEM	COSP#	Vendor	QTY	U/M
28	STAINLESS STEEL SHELF	SSW26AX20B	COSPOLICH	2	EA
29	BREAKER, 15 AMP, 2-POLE	PCCC55	COSPOLICH	7	EA
30	TERMINAL END STOP	PCTES35	COSPOLICH	2	EA
31	TERMINAL SECTION	PCTWK10/U	COSPOLICH	2	EA
32	EXPANSION VALVE, FS-1/4-C	RWEV27	COSPOLICH	1	EA
33	EXPANSION VALVE, FS-1/4-Z	RWEV28	COSPOLICH	1	EA
34	BALL VALVE, 1/2"	RWIV13	COSPOLICH	7	EA
35	SOLENOID COIL, MKC-1, 115V	RWSC01	COSPOLICH	2	EA
36	SOLENOID VALVE, A3S1, 1/4" ODF	RWSV01	COSPOLICH	2	EA
37	SECONDARY BREAKER STRIP, 19"	HXBS19	COSPOLICH	4	EA
38	SECONDARY BREAKER STRIP, 27"	HXBS27	COSPOLICH	4	EA
39	DOOR HINGE	HXHE02	COSPOLICH	4	EA
40	DOOR LATCH	HXLH06	COSPOLICH	2	EA
41	T-HANDLE LATCH	HXLH30	COSPOLICH	1	EA
42	T-HANDLE LATCH RODS	HXLH30R	COSPOLICH	2	EA
43	BREAKER STRIP CORNER	HXBSC01	COSPOLICH	8	EA
44	COLD FOOD COUNTER ON/OFF SWITCH WITH HARNESS	MT-009	COSPOLICH	1	EA
45	FILTER DRYER	RWFD02	COSPOLICH	1	EA
46	SHELF CLIPS	HXCS01	COSPOLICH	12	EA
47	SHELF STANDARD, 36"	HXSD36	COSPOLICH	4	EA
48	LIGHT FIXTURE	LRLF01	COSPOLICH	1	EA
49	LIGHT BULB, 40W, 115V	LRSB01	COSPOLICH	1	EA
50	EPR VALVE, 1/2" SAE, ORIT6	RWEP03	COSPOLICH	1	EA
51	FRONT-BREATHING GRILL MOTOR	RWEM03	COSPOLICH	1	EA
52	FRONT-BREATHING GRILL MOTOR MOUNTING BRACKET	RWEM03M	COSPOLICH	1	EA
53	FRONT-BREATHING GRILL FAN GUARD	RWE5054D	COSPOLICH	1	EA
54	SIGHT GLASS	RWSG01	COSPOLICH	1	EA

Table A – Parts List for LPD242

55	ITEM	COSP#	Vendor	QTY	U/M
56	PRESSURE SWITCH	RWPL02	COSPOLICH	1	EA
57	LIGHTED ROCKER SWITCH	LWSR01	COSPOLICH	1	EA
58	DOOR ASSEMBLY	DD67S	COSPOLICH	2	EA
59	DOOR GASKET	GD67MV	COSPOLICH	2	EA
60	LIGHT SWITCH ACTIVATOR	EX96S	COSPOLICH	2	EA
61	HOT WELL, 115V	DIHW-N	COSPOLICH	7	EA